

vtech[®]
Baby

User's Manual

Learning Fun Party Set



© 2014 VTech
Printed in China
91-002936-001 

VTech understands that a child's needs and abilities change as they grow and with that in mind we develop our toys to teach and entertain at just the right level...

vtech *Baby*

Toys that will stimulate their interest in different textures, sounds and colours

I am...

...responding to colours, sounds and textures

...understanding cause and effect

...learning to touch, reach, grasp, sit-up, crawl and toddle

Birth-36 months



Pre-School

Interactive toys to develop their imagination and encourage language development

I want...

...to get ready for school by starting to learn the alphabet and counting

...my learning to be as fun, easy and exciting as can be

...to show my creativity with drawing and music so my whole brain develops

3-6 years



Electronic Learning Computers

Cool, aspirational and inspiring computers for curriculum related learning

I need...

...challenging activities that can keep pace with my growing mind

...intelligent technology that adapts to my level of learning

...National Curriculum based content to support what I'm learning at school

4-10 years



To learn more about this and other VTech® products, visit www.vtechuk.com

INTRODUCTION

Thank you for purchasing the **VTech® Learning Fun Party Set**.

Play and learn with the **Learning Fun Party Set** by **VTech®**. This interactive play set includes a jug of pretend squash, cups and sweet treats to share with friends. Put the play set pieces on the tray to see this jug and tray light-up and learn about colours, shapes, food and more!

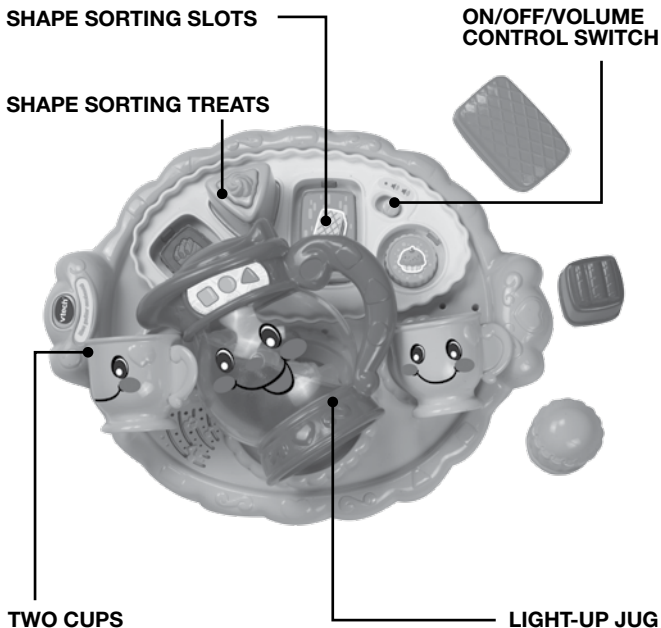

INCLUDED IN THIS PACKAGE

- One VTech® Learning Fun Party Set electronic tray
- One jug
- Two cups
- Four shape sorting treats
- One user's manual

WARNING: All packing materials, such as tape, plastic sheets, packaging locks, wire ties and tags are not part of this toy, and should be discarded for your child's safety.

NOTE: Please keep this user's manual as it contains important information.

Please cut and discard the cord that attaches the treat to the product. The cords are not part of this toy and should be discarded for your child's safety.

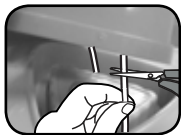

Unlock the packaging locks:

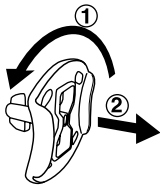

① Rotate the packing locks 90 degrees counter-clockwise

② Pull out the packing locks

GETTING STARTED

BATTERY INSTALLATION

1. Make sure the unit is turned **OFF**.
2. Locate the battery cover on the bottom of the electronic tray. Use a screwdriver to loosen the screw.
3. Install 2 new 'AA' (AM-3/LR6) batteries following the diagram inside the battery box. (The use of new alkaline batteries is recommended for maximum performance.)
4. Replace the battery cover and tighten the screw to secure.

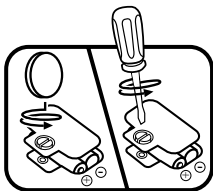

BATTERY NOTICE

- Use new alkaline batteries for maximum performance.
- Use only batteries of the same or equivalent type as recommended.
- Do not mix different types of batteries: alkaline, standard (carbon-zinc) or rechargeable (Ni-Cd, Ni-MH), or new and used batteries.
- Do not use damaged batteries.
- Insert batteries with the correct polarity.
- Do not short-circuit the battery terminals.
- Remove exhausted batteries from the toy.
- Remove batteries during long periods of non-use.
- Do not dispose of batteries in fire.
- Do not charge non-rechargeable batteries.
- Remove rechargeable batteries from the toy before charging (if removable).
- Rechargeable batteries are only to be charged under adult supervision.

Disposal of batteries and product



The crossed-out wheellie bin symbols on products and batteries, or on their respective packaging, indicates they must not be disposed of in domestic waste as they contain substances that can be damaging to the environment and human health.



The chemical symbols Hg, Cd or Pb, where marked, indicate that the battery contains more than the specified value of mercury (Hg), cadmium (Cd) or lead (Pb) set out in Battery Directive (2006/66/EC).

The solid bar indicates that the product was placed on the market after 13th August, 2005.

Help protect the environment by disposing of your product or batteries responsibly.



For more information, please visit:

www.recycle-more.co.uk

www.recyclenow.com

PRODUCT FEATURES

1. ON/OFF/VOLUME CONTROL SWITCH

To turn the unit **ON**, slide the **ON/OFF/VOLUME CONTROL SWITCH** to the **LOW VOLUME** () or **HIGH VOLUME** () position. To turn the unit **OFF**, slide the **ON/OFF/VOLUME CONTROL SWITCH** to the **OFF** () position.



2. AUTOMATIC SHUT-OFF

To preserve battery life, the **VTech® Learning Fun Party Set** will automatically power-down after approximately one minute without input. The unit can be turned on again by inserting or removing one of the play pieces from the tray or by pressing any button.

ACTIVITIES

1. Slide the **on/off/volume control switch** to turn the unit on. You will hear a fun sound, a song and a phrase. The light will flash with the sounds.



2. Press the **shape buttons** to learn shapes or hear playful sing-along songs and fun sounds. The light will flash with sounds.



3. Press the **light-up button** to hear a playful phrase, fun sounds or a sing-along song. The light will flash with sounds.



4. Insert the **jug** or the **treats** into the corresponding slot on the tray to learn colours and objects and hear playful sing-along songs. The light will flash with sounds.



5. Remove the **jug** or the **treats** from the tray to hear playful phrases and melodies. The light will flash with sounds.

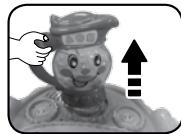

6. If there is no input to the tray after approximately 8 seconds, you will hear a random question. After another 8 seconds without input, you will hear a sing-along song. If there is no input after another 8 seconds, the unit will play a short tune and automatically power down.

SING-ALONG SONG LYRICS

SONG 1

It's time for a party.
There are lots of treats.
All different shapes.
Yummy, I like party time.

SONG 2

It's time for a party.
We'll pour some squash,
And eat some treats.
Spending time with you is sweet!

SONG 3

Mmm, biscuits are a sweet and crunchy treat!

SONG 4

Yum, cheesecake is a rich and creamy little treat!

SONG 5

The cake smells delicious, can't wait to take a bite!

SONG 6

Who doesn't love a cupcake with sprinkles on top?

MELODY LIST

1. Boys & Girls Go Out to Play
2. White Coral Bells
3. Bicycle Built For Two
4. While Strolling Through the Park
5. Lavender's Blue
6. A-Ticket, A-Tasket
7. Mary, Mary Quite Contrary
8. Little Miss Muffet

9. A, B, C Tumble Down D
10. Good Morning Merry Sunshine
11. Hot Cross Buns
12. Peas Porridge Hot
13. Little Bo Peep
14. Muffin Man
15. Polly Put the Kettle On
16. Simple Simon
17. Sing a Song of Sixpence
18. Three Little Kittens
19. Ring Around the Rosy
20. Pop! Goes the Weasel

CARE & MAINTENANCE

1. Keep the unit clean by wiping it with a slightly damp cloth.
2. Keep the unit out of direct sunlight and away from any direct heat source.
3. Remove the batteries when the unit will not be in use for an extended period of time.
4. Do not drop the unit on hard surfaces and do not expose the unit to moisture or water.

TROUBLESHOOTING

If for some reason the program/activity stops working or malfunctions, please follow these steps:

1. Please turn the unit **OFF**.
2. Interrupt the power supply by removing the batteries.
3. Let the unit stand for a few minutes, then replace the batteries.
4. Turn the unit **ON**. The unit should now be ready to play again.
5. If the product still does not work, replace with an entire set of new batteries.

If the problem persists, please call our Consumer Services Department on 01235 546810 (from UK) or +44 1235 546810 (outside UK) and a service representative will be happy to help you.

IMPORTANT NOTE:

Creating and developing **VTech®** products is accompanied by a responsibility that we take very seriously. We make every effort to ensure the accuracy of the information, which forms the value of our products. However, errors sometimes can occur. It is important for you to know that we stand behind our products and encourage you to call our Consumer Services Department on 01235 546810 (from UK) or +44 1235 546810 (outside UK), with any problems and/or suggestions that you might have. A service representative will be happy to help you.





vtech®

PRODUCT WARRANTY



Thank you for choosing this quality product from VTech. We hope it will bring many hours of entertainment, imaginative play and learning.

1. The product detailed above is covered by a one year warranty from the date of purchase, against any defects in materials or workmanship.
2. The product may be returned to the place of purchase. Alternatively the product can be returned to VTech Electronics Europe plc (see address below), with proof of purchase, without proof of purchase no replacement will be provided.
3. VTech Electronics Europe plc will examine the product and if it is found to be defective due to faulty materials or workmanship, will replace the product at their discretion.
4. If the product covered by this warranty is damaged due to misuse, modification or unauthorised repair, or because of faulty batteries, battery discharge or incorrect electrical connections, then this warranty becomes void.
5. This warranty is personal to the original purchaser and is not transferable.
6. Breakages to the LCD screen are not covered by the warranty.
7. Returns to VTech Electronics Europe plc should include a cheque or postal order for £1.50 towards the cost of return postage and packaging.
8. Products returned to VTech Electronics Europe plc, should be addressed as follows and packed carefully to avoid damage in transit (Please do not include batteries or adaptor).
Please include details of the fault together with your name and address.

VTech Electronics Europe plc, c/o Tablogix Limited, 200 Milton Park, Abingdon, Oxon OX14 4TA

THIS WARRANTY IS OFFERED AS AN EXTRA BENEFIT AND DOES NOT AFFECT CONSUMERS' STATUTORY RIGHTS.

Join the VTech club online at www.vtechuk.com

This warranty is valid for the UK and Eire only. For products purchased outside the UK and Eire, please contact your local distributor or place of purchase.